

■ Procedure to attach the fixed 2-finger option for ARH350A

20210609  
ASPINA  
ALBU

● Contents

NO.	PARTS	PCS
1	Fixed-2 Finger Option	1
2	Screws M4 × 10	2
3	Parallel Pin	1

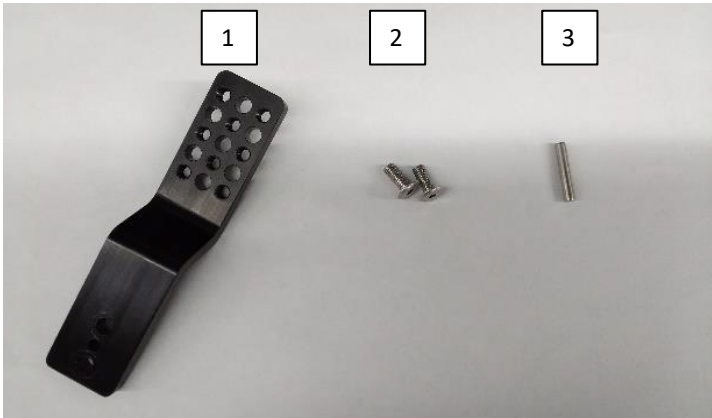

● Mounting procedure

1. Remove the 2 fingers from robotic gripper as following picture.

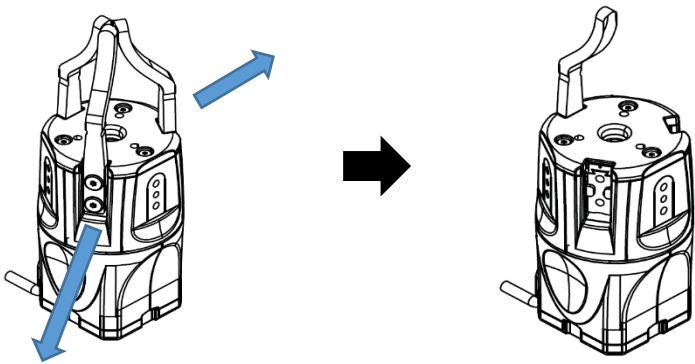

2. Fix the 2 fingers option with the screws and parallel pin.  
It can be attached opposite direction.  
Depending on the direction of 2 fingers option, the stroke width changes.

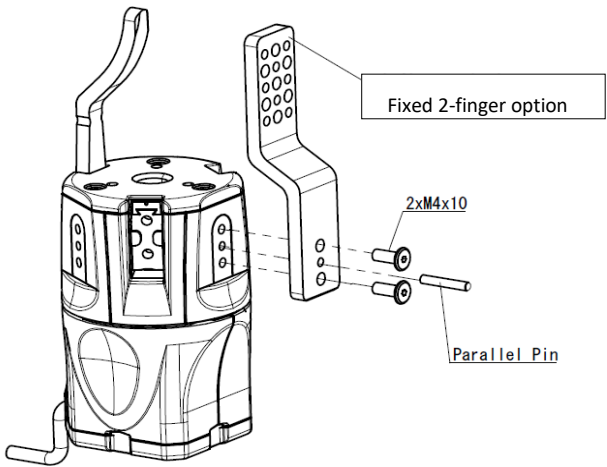

3.Remove the parallel pin.

